

Assembly male to female connector metal straight PG9 with shield

Gender: Male to Female
Type: adapter
Part Number: CC112-SA001-xx

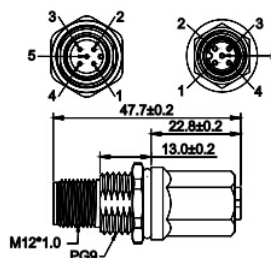

General Characteristics

Number of contact	2	3	4	5	8	12
Replace "-xx" with:	-02	-03	-04	-05	-08	-12
Locking system	screw M12*1.0					
Termination	Front Mounting					
Shell protection	IP67/IP68					
Mechanical operation	>500 mating cycles					
Upper temperature	+85 °C					
Lower temperature	-25 °C					

Electrical Characteristics

Rated voltage	125V					
Rated impulse voltage	1.5KV					
Pollution degree	III					
Test voltage	1750V±15V					
Rated current (40 °C)	3A	4A	2A	1.5A		
Contact resistance	≤3mΩ					
Insulation resistance	≥10 ³ MΩ					

Materials

Pin contact	CuZn
Socket contact	CuSn
Contact plating	Au
Upper temperature	PA66(UL 94V-0)
Female insert	PA66(UL 94V-0)
Material of Body	PVC or PUR
Screw	CuZn
Nut	CuZn

Assembly male to male connector metal straight PG9 with shield

Gender: Male to Male

Type: adapter

Part Number: CC112-SA002-xx

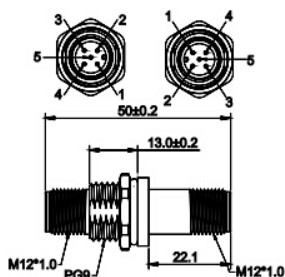

General Characteristics

Number of contact	2	3	4	5	8	12
Replace "-xx" with:	-02	-03	-04	-05	-08	-12
Locking system	screw M12*1.0					
Termination	Front Mounting					
Shell protection	IP67/IP68					
Mechanical operation	>500 mating cycles					
Upper temperature	+85 °C					
Lower temperature	-25 °C					

Electrical Characteristics

Rated voltage	125V				
Rated impulse voltage	1.5KV				
Pollution degree	III				
Test voltage	1750V±15V				
Rated current (40 °C)	3A	4A	2A	1.5A	
Contact resistance	≤ 3 mΩ				
Insulation resistance	≥ 10 ³ MΩ				

Materials

Pin contact	CuZn
Socket contact	CuSn
Contact plating	Au
Upper temperature	PA66(UL 94V-0)
Female insert	PA66(UL 94V-0)
Material of Body	PVC or PUR
Screw	CuZn
Nut	CuZn

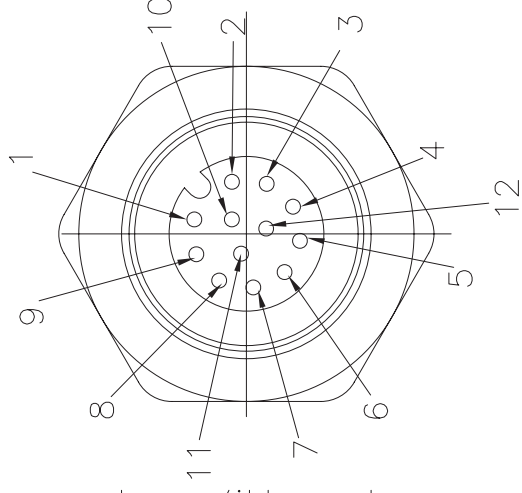
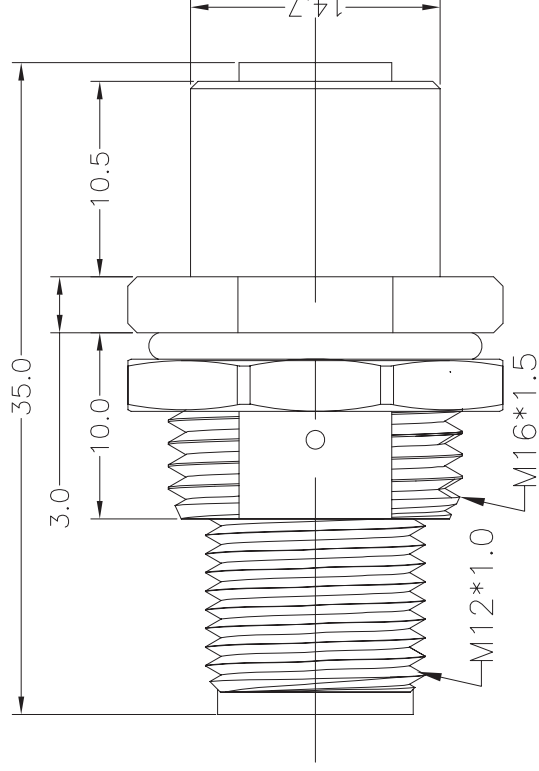
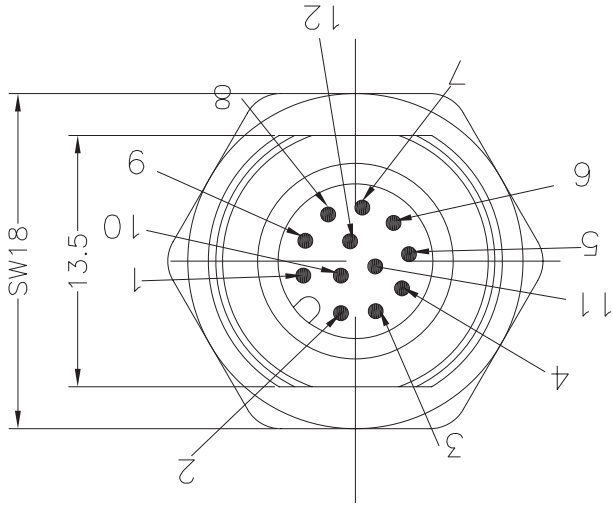

1. Electrical character
- Rating voltage: 250V AC/DC ,
- Voltage proof: contacts: 1200V±15VDC 60S
2. Insulation resistance >100MΩ
3. Rating current: 4A
4. Contact resistance ≤10mΩ
5. Other Specification
- Contact PIN: Brass with Gold plating 1u".
- Coupling nut/screw: Brass with nickel plating
- Insulation plastic: PA66+GF
- Degree of protection: IP67/IP68
- Operating temperature: -25°C ~ +90°C

REV	DESCRIPTION	DATE	APPROVED
S0	CREATED DRAWING	2016/03/28	YMX

TITLE		M12 A 12P/M TO F	
PART NO		CC112-SA001-12	
REV.			
DRAWN BY	DATE		
CHECKED BY	DATE		
APPROVED BY	DATE		
TOLERANCES ARE:		THIRD ANGLE PROJECTION	
DECIMALES	ANGLES	PROJECTION	
.x ±0.15	x' ±1.0'	SIZE:	A4
.xx ±0.10	.x' ±0.5'	SCALE:	
UNITS:		mm	
SHEET:		1 OF 1	